

QA-EV



Scheme Ref.	CPZ Q - EV BAYS	x-height	15.0
Sign Ref.	QA-EV	SIGN FACE	
Letter colour	BLACK	Width	290mm
Background	WHITE	Height	345mm
Border	BLACK	Area	0.10m ²
Material	Class R3B Microprismatic		

EV-S



Scheme Ref.	CPZ R - EV SIGN	x-height	15.0
Sign Ref.	EV-S	SIGN FACE	
Letter colour	BLACK	Width	320mm
Background	WHITE	Height	115mm
Border	BLACK	Area	0.04m ²
Material	Class R3B Microprismatic		

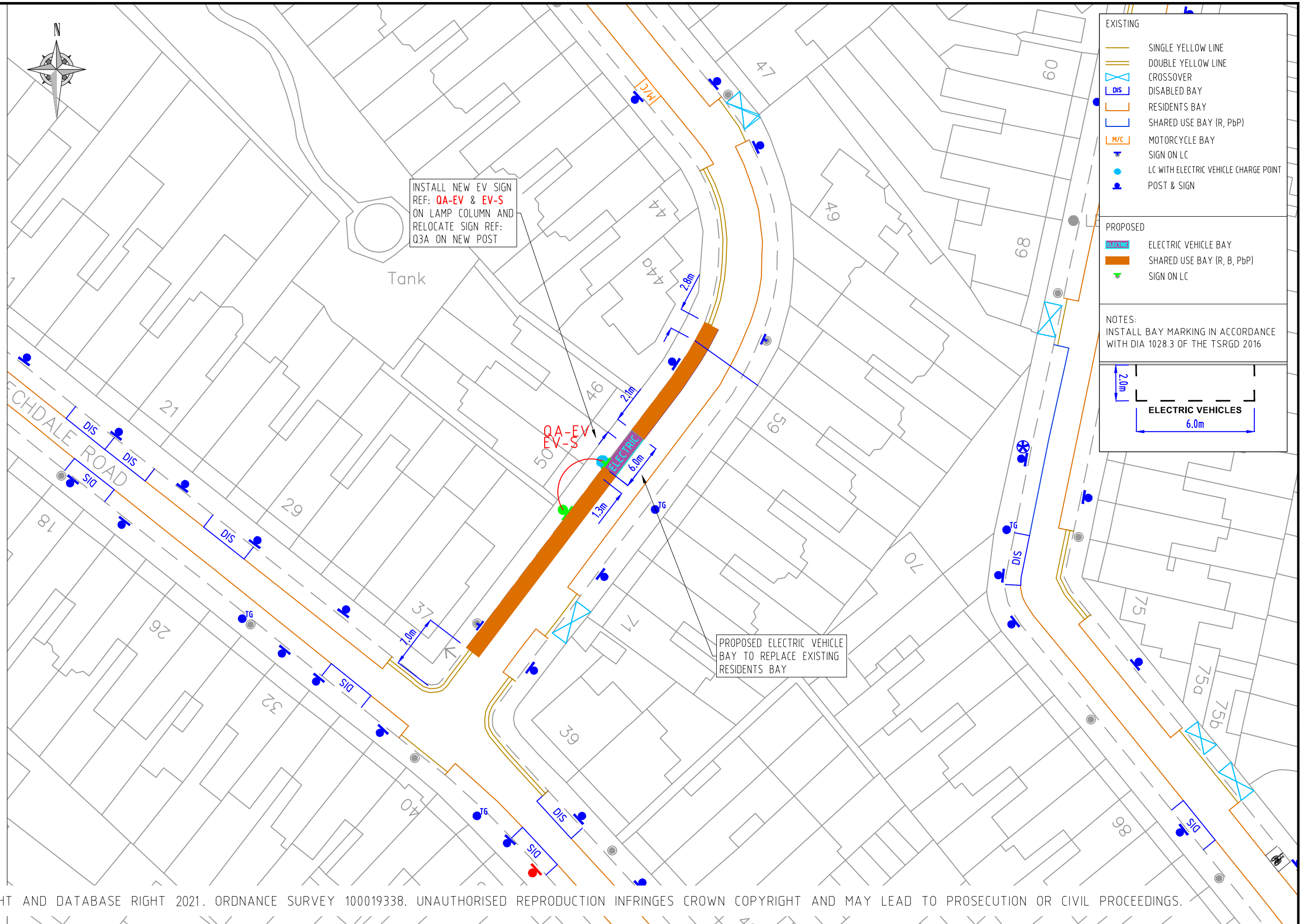

© CROWN COPYRIGHT AND DATABASE RIGHT 2021. ORDNANCE SURVEY 100019338. UNAUTHORISED REPRODUCTION INFRINGES CROWN COPYRIGHT AND MAY LEAD TO PROSECUTION OR CIVIL PROCEEDINGS.

NOTES:

REV	DESCRIPTION	DRAWN	SIG	DATE	CHKD	SIG	DATE	APP	SIG	DATE

Lambeth
 PARKING, STREET MANAGEMENT AND COMMERCIAL,
 3RD FLOOR, CIVIC CENTRE
 6 BRIXTON HILL
 LONDON, SW2 1EG
 020 7926 9000

DRAWN	AF	PROJECT	PROPOSED ELECTRIC VEHICLE PARKING
CHKD	GWA	DRAWING TITLE	FAIRMOUNT ROAD (CPZ 'Q')
APP	LM	CLASSIFICATION	TMO
		PAPER	A3
		SCALE	1:500
DATE	14/10/21	DRAWING NO	DES-CPZ-EVB-1001-001-22
		REVISION	-