

QA-EV

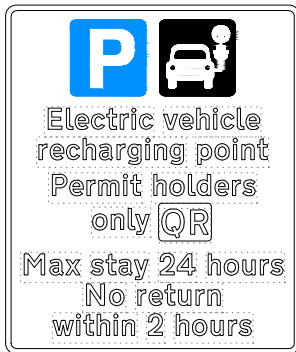

| | | | |
|---------------|--------------------------|-----------|--------------------|
| Scheme Ref. | CPZ S - EV BAYS | | |
| Sign Ref. | QA-EV | x-height | 15.0 |
| Letter colour | BLACK | SIGN FACE | |
| Background | WHITE | Width | 290mm |
| Border | BLACK | Height | 345mm |
| Material | Class R38 Microprismatic | Area | 0.10m ² |

EV-S



| | | | |
|---------------|--------------------------|-----------|--------------------|
| Scheme Ref. | CPZ R - EV SIGN | | |
| Sign Ref. | EV-S | x-height | 15.0 |
| Letter colour | BLACK | SIGN FACE | |
| Background | WHITE | Width | 320mm |
| Border | BLACK | Height | 115mm |
| Material | Class R38 Microprismatic | Area | 0.04m ² |

QA

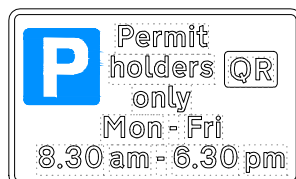

| | | | |
|---------------|--------------------------|-----------|--------------------|
| Scheme Ref. | CPZ - EV SIGN | | |
| Sign Ref. | QA | x-height | 15.0 |
| Letter colour | BLACK | SIGN FACE | |
| Background | WHITE | Width | 290mm |
| Border | BLACK | Height | 175mm |
| Material | Class R38 Microprismatic | Area | 0.05m ² |

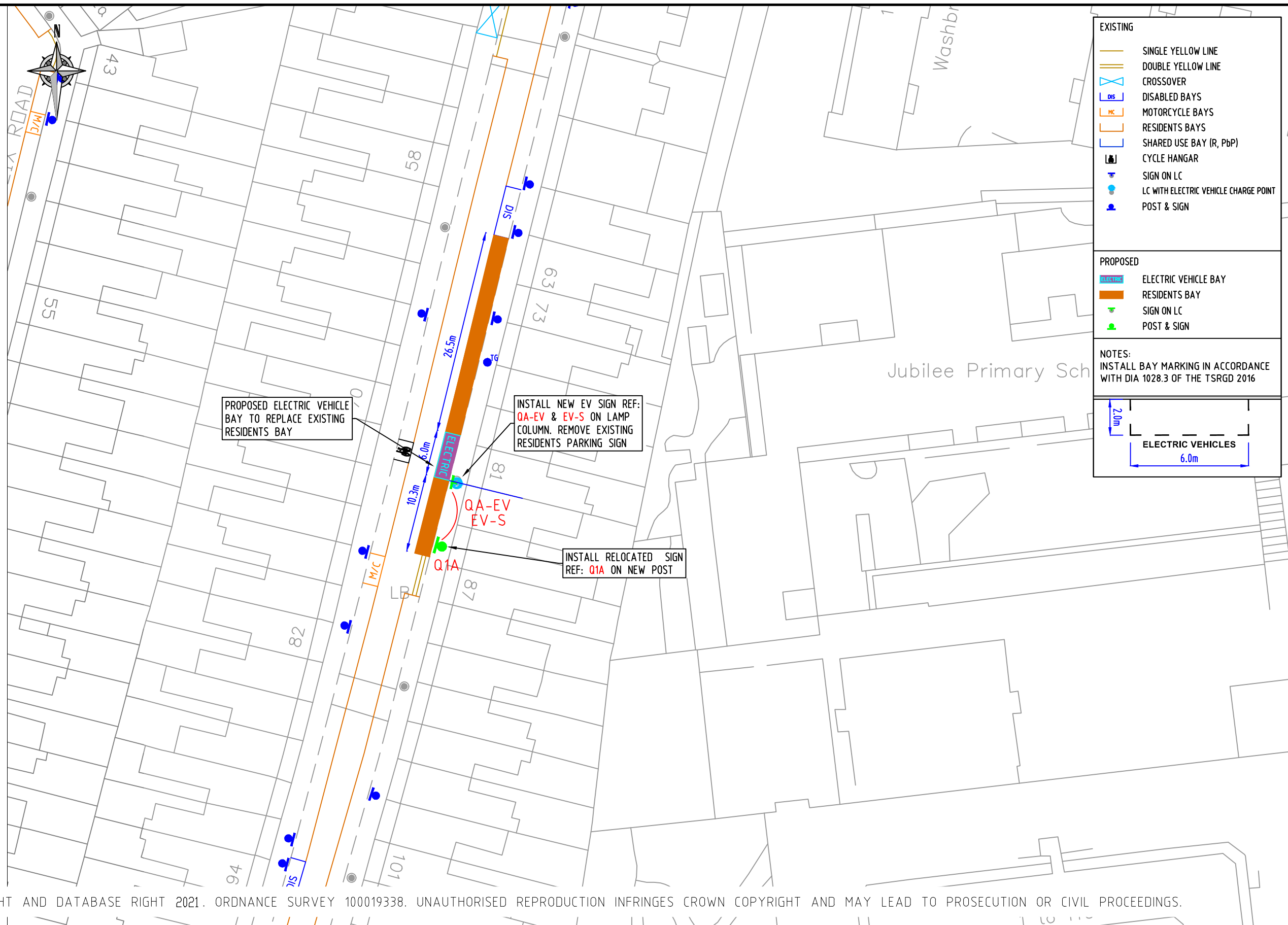

EXISTING

- SINGLE YELLOW LINE
- DOUBLE YELLOW LINE
- CROSSOVER
- DISABLED BAYS
- MOTORCYCLE BAYS
- RESIDENTS BAYS
- SHARED USE BAY (R, P&P)
- CYCLE HANGAR
- SIGN ON LC
- LC WITH ELECTRIC VEHICLE CHARGE POINT
- POST & SIGN

PROPOSED

- ELECTRIC VEHICLE BAY
- RESIDENTS BAY
- SIGN ON LC
- POST & SIGN

NOTES:
INSTALL BAY MARKING IN ACCORDANCE WITH DIA 1028.3 OF THE TSRGD 2016

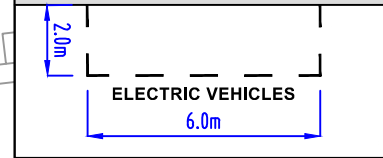

© CROWN COPYRIGHT AND DATABASE RIGHT 2021. ORDNANCE SURVEY 100019338. UNAUTHORISED REPRODUCTION INFRINGES CROWN COPYRIGHT AND MAY LEAD TO PROSECUTION OR CIVIL PROCEEDINGS.

NOTES:

| REV | DESCRIPTION | DRAWN | SIG | DATE | CHKD | SIG | DATE | APP | SIG | DATE |
|-----|-------------|-------|-----|------|------|-----|------|-----|-----|------|
| | | | | | | | | | | |
| | | | | | | | | | | |
| | | | | | | | | | | |
| | | | | | | | | | | |
| | | | | | | | | | | |
| | | | | | | | | | | |
| | | | | | | | | | | |
| | | | | | | | | | | |
| | | | | | | | | | | |
| | | | | | | | | | | |

Lambeth
 PARKING, STREET MANAGEMENT AND COMMERCIAL,
 3RD FLOOR, CIVIC CENTRE
 6 BRIXTON HILL
 LONDON, SW2 1EG
 020 7926 9000

| | | | | | |
|-------|----------|----------------|-----------------------------------|-------|----------|
| DRAWN | SC | PROJECT | PROPOSED ELECTRIC VEHICLE PARKING | | |
| CHKD | GWA | DRAWING TITLE | LEANDER ROAD (CPZ Q) | | |
| APP | LM | CLASSIFICATION | TMO | PAPER | A3 |
| | | SCALE | 1:500 | | |
| DATE | 27.08.21 | DRAWING NO | DES-CPZ-EVB-1002-001-46 | | REVISION |
| | | | | | - |