

KC-EV

P 

Electric vehicle recharging point
Permit holders only **KSR****KSB**
Max stay 24 hours
No return within 2 hours

Scheme Ref.	CPZ K - EV Bays	x-height	15.0
Sign Ref.	KC-EV	SIGN FACE	
Letter colour	BLACK	Width	281mm
Background	WHITE	Height	335mm
Border	BLACK	Area	0.09m ²
Material	Class R3B Microprismatic		

EV-S

You must be actively charging to park in this bay

Scheme Ref.	CPZ R - EV SIGN	x-height	15.0
Sign Ref.	EV-S	SIGN FACE	
Letter colour	BLACK	Width	320mm
Background	WHITE	Height	115mm
Border	BLACK	Area	0.04m ²
Material	Class R3B Microprismatic		

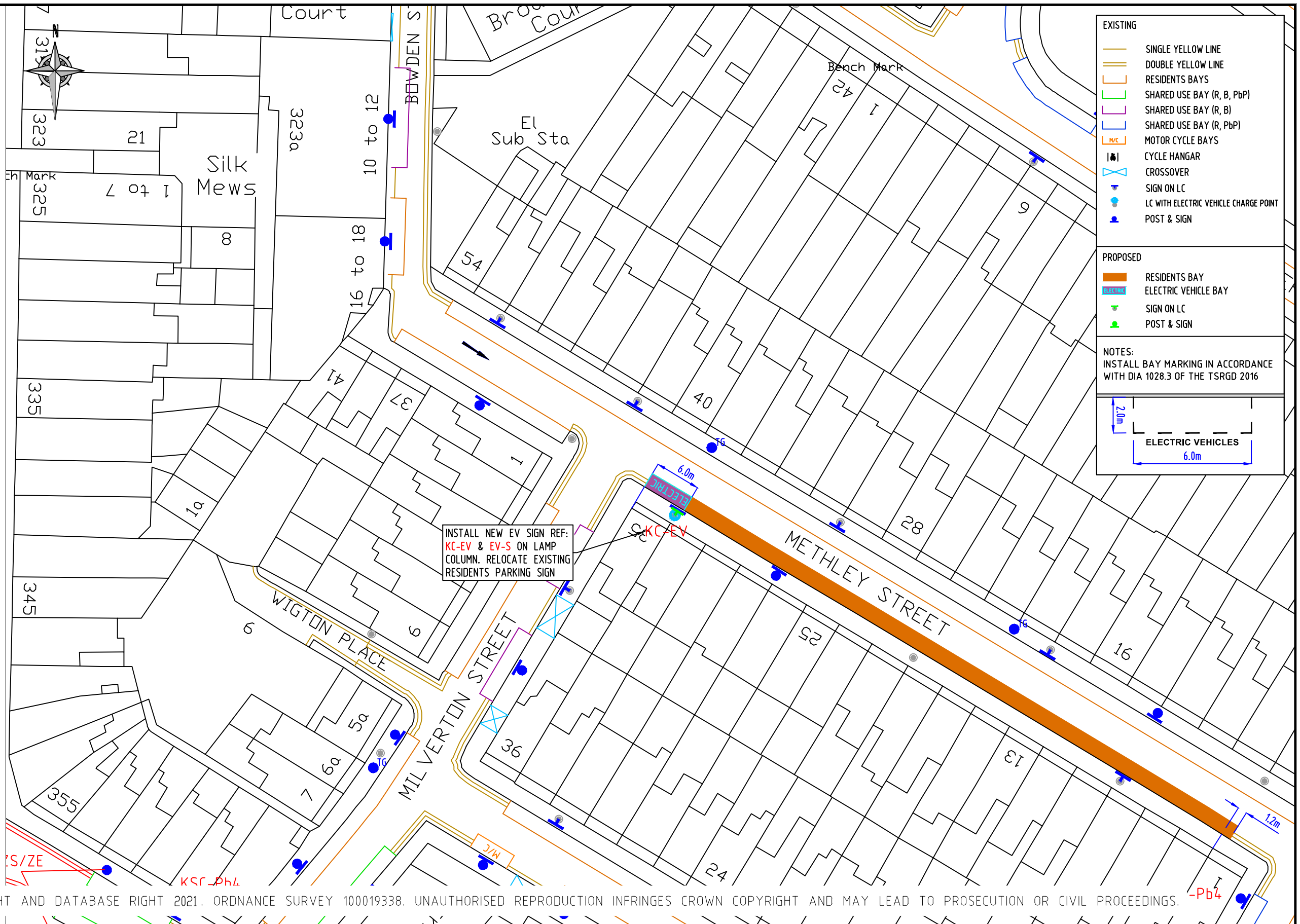

NOTES:

REV	DESCRIPTION	DRAWN	SIG	DATE	CHKD	SIG	DATE	APP	SIG	DATE

Lambeth

PARKING, STREET MANAGEMENT AND COMMERCIAL,
3RD FLOOR, CIVIC CENTRE
6 BRIXTON HILL
LONDON, SW2 1EG
020 7926 9000

DRAWN	RT	PROJECT	PROPOSED ELECTRIC VEHICLE PARKING		
CHKD	GWA	DRAWING TITLE	METHLEY STREET (CPZ K)		
APP	LM	CLASSIFICATION	TMO	PAPER	A3
		SCALE	1:500		
DATE	18/05/21	DRAWING NO	DES-CPZ-EVB-1000-001-63	REVISION	-